

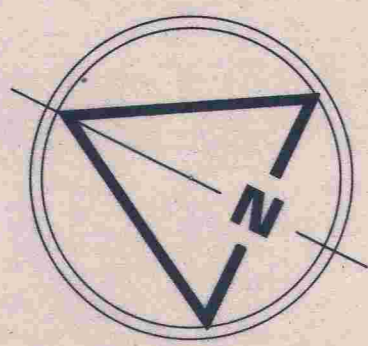

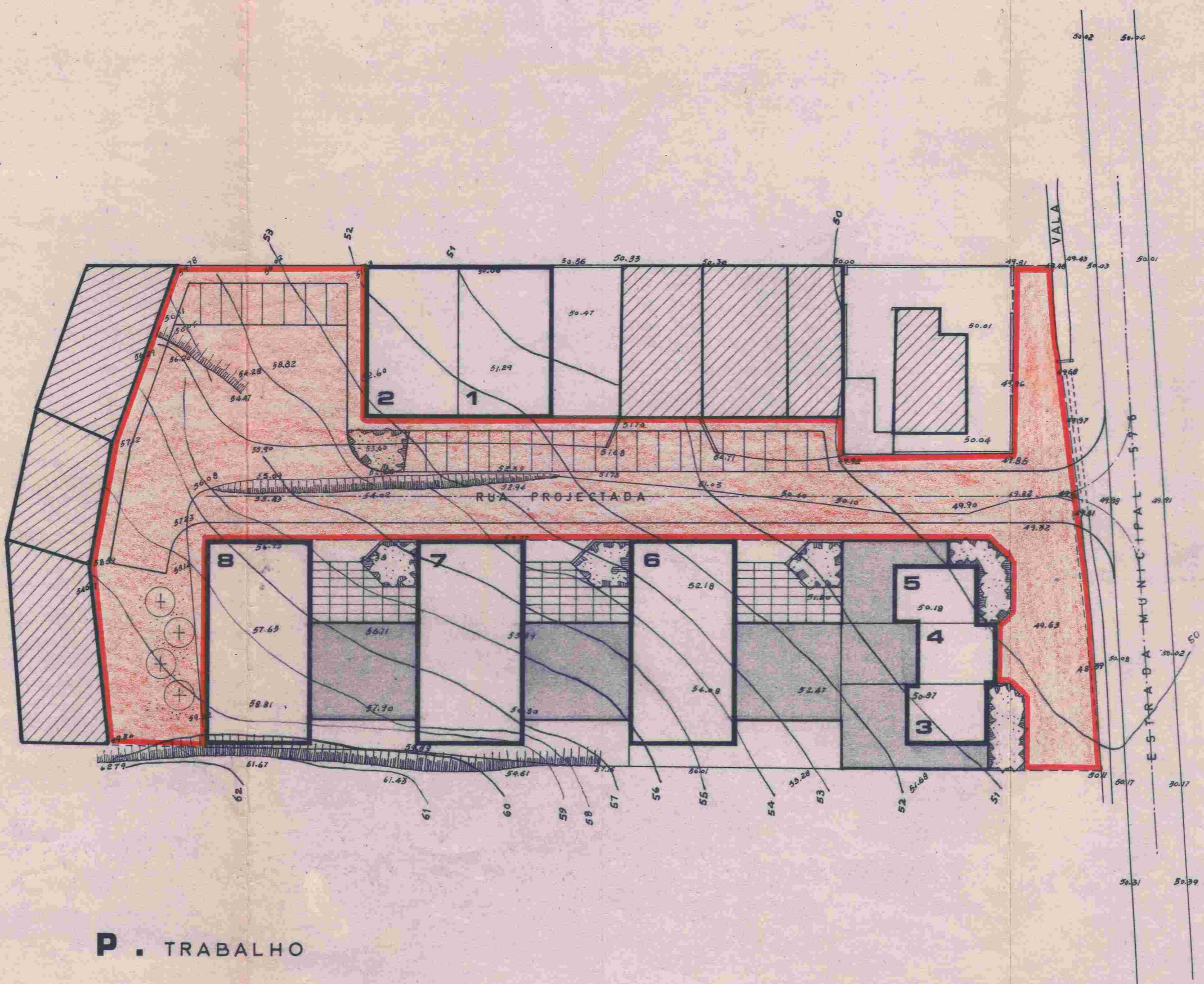

Alameda 117/74



CÂMARA MUNICIPAL  
LOURES  
30 JAN 1974  
ENTRADA



-  CONSTRUÇÕES EXISTENTES
-  PROJECTADAS - 1 PISO = ÁREA TOTAL 663,00 M.2
-  PROJECTADAS - 2 PISOS = ÁREA TOTAL 3.084,00 M.2
-  ÁREA DO TERRENO A CEDER À C.M.L. 2.587,00 M.2

P . TRABALHO

PLANO		 ARQ. A.F. AMORIM • 20 REF.	DES. N.º
<b>ODIVELAS</b>			<div style="border: 1px solid black; width: 30px; height: 30px; text-align: center; line-height: 30px; font-size: 24px; font-weight: bold;">1</div>
P. TRABALHO	ESCALA 1:500	PROCESSO 32.442	